

Business Unit Components &amp; Equipment

# Speed-Control Plug'n'Dose AM version

## Dosing technology Dosing system

```

CASE 5   UF=1           GOSUB4 ' Call MenuOptions ' Print out
GOSUB4   UFO ' Call MenuOptionsUE=0 ' Print out Menu option
UE=1     q=UGA         ' Check Go switch
UEO     WHILE q<700   UF=1
UF=1     UE=0         ' Need to toggle Port E to show
UFO     q=UGA         q=UGA ' Check Go
q=UGA   IF UGI==0 ' Check Go is selected
WHILE q<700 WHILE UGI==0 LOOP UGA
q=UGA   GOSUB17 ' Run that Demo subroutine
IF UGI=1 ENDIF ' IF Go is selected WHILE UGI==0 LOOP
WHILE UGI==0 LOOP GOSUB16 ' Run that Demo
GLOOP5 ' Run that Demo subroutine
E BREAK LOOP
  
```



### PRODUCT DESCRIPTION

The preeflow Speed Control 'plug'n'dose' AM control unit has been developed specifically for applications in automation.

### OPERATING PRINCIPLE

Microprocessor-controlled. External signals such as the dosing speed and dosing time of a superior control unit, for example an SPS, are processed further and control the eco-PEN's dosing process.

The integrated motor monitoring as overload protection for the dispenser can be processed as an error message.

Fig.: Front view

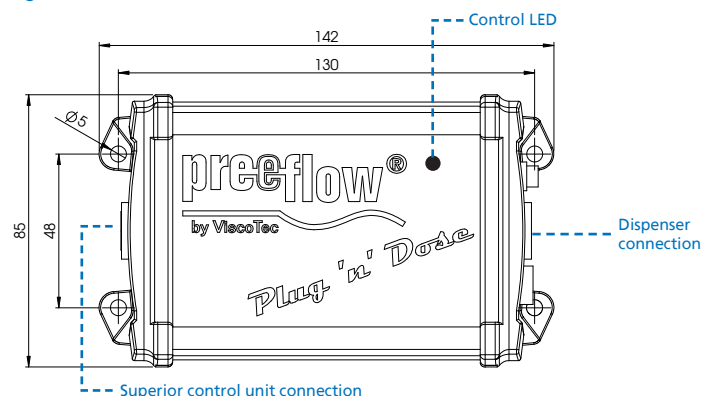

Connection

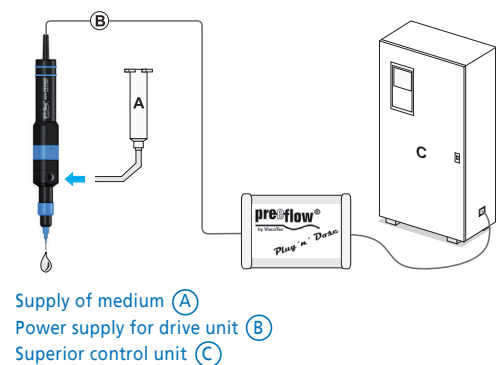

### TECHNICAL DATA

|                         |   |
|-------------------------|---|
| Dimensions (W x H x D): | 142 x 85 x 50 mm                                    |
| Mounting:               | 4 holes / 5 mm, hole interval 130 x 48 mm           |
| Weight                  | Approx. 260 g                                       |
| Supply voltage:         | 24 V DC   |
| Mains adapter:          | Not included  |
| Consumption / rating:   | 100 VA / 2.7 A                                      |
| Operating conditions:   | +10°C to +40°C (non-condensing), air pressure 1 bar |
| Storage conditions:     | Dry / dust-free, -10°C to +40°C                     |

**preeflow**®  
by ViscoTec

info@preeflow.com | www.preeflow.com

© ViscoTec Pumpen und Dosiertechnik GmbH  
02/10 – Subject to technical changes,  
typographical errors and misprints reserved.